

**Boardwalk**

# Swann House

## REDCLIFFE

APPROXIMATE FLOOR AREA  
62.3 SQM / 671 SQFT

BOOK A VIEWING  
01174 532 985  
hello@boardwalkpropertyco.com

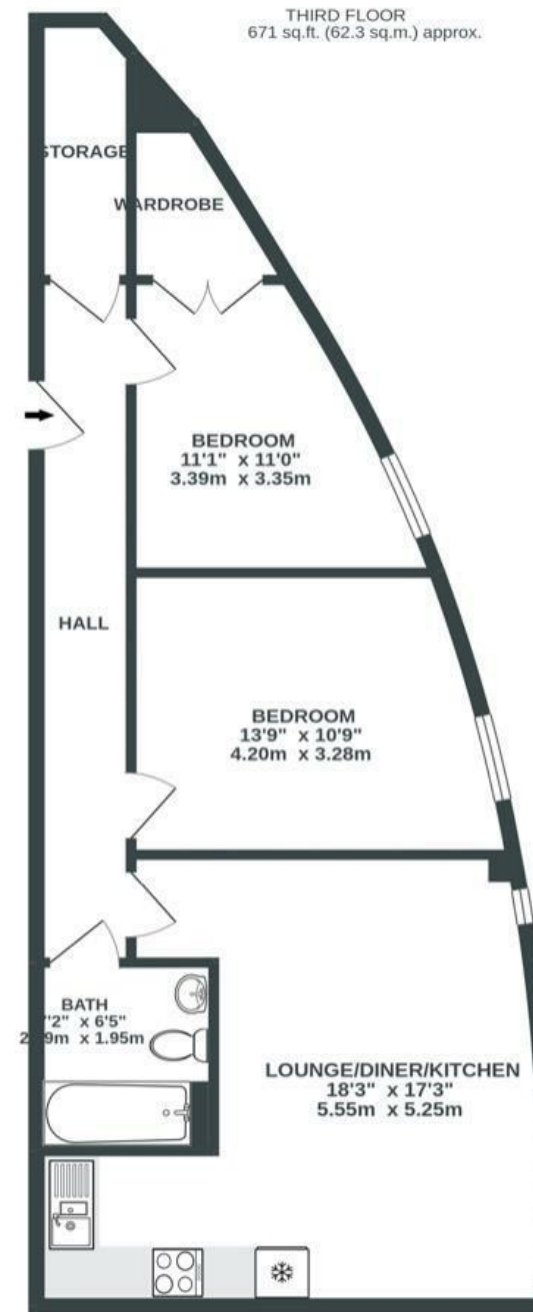

Illustrations are for reference purposes only, measurements are approximate, not to scale.

~~Boardwalk~~

# Ferry Street , BRISTOL

£

£310,000

ZZ

2 Bedrooms



Bristol, BS1

6LT



1 Bathrooms

*What a location! This flat has been our home for five and a half years now and we'll be sad to say goodbye to it. We love the neighbourhood and it's proximity to so many different aspects of Bristol - from Wapping Wharf and the floating harbour, and Queen Square to the city centre - you're never short of something new to explore. Amazing pubs, restaurants, shops and some of Bristol's most iconic scenery are all quite literally on your doorstep. The variety of things to do and places to go are really special.'*

